

# International Eyelets, Inc.

## Flat Flange Eyelets

FLAT FLANGE		A	B	C	D
Nominal Board Thickness	IEI PART NUMBER	Barrel O.D. .002+/-	Length Under Flange .002+/-	Flange Dia. .002+/-	Barrel I.D. .002+/-
.015"	F-3032-C	.030	.028	.046	.020
	F-4747-C	.047	.048	.080	.035
	F-4747-B	.047	.048	.080	.035
	F-3054-C	.030	.054	.046	.020
0.31"	F-4032-C	.040	.062	.060	.030
	F-4762-C	.047	.062	.080	.033
	F-4762-B	.047	.062	.080	.033
	F-6062-B	.059	.062	.090	.045
	F-1163-C	.118	.063	.187	.101
	F-3070-C	.030	.073	.046	.020
.062"	F-3093-C	.030	.094	.046	.020
	F-4093-C	.039	.093	.060	.030
	F-6093-C	.058	.093	.090	.046
	F-6892-B	.068	.092	.087	.056
	F-4895-C	.048	.095	.080	.038
	F-4895-B	.048	.095	.080	.038
	F-4710-C	.048	.102	.072	0.36
	F-6010-C	.059	.105	.090	.045
	F-6011-B	.059	.110	.090	.048
.093"	F-1111-B	.111	.117	.180	.095
	F-3012-C	.030	.120	.046	.020
	F-4012-C	.040	.125	.060	.031
	F-4712-C	.047	.125	.080	.035
	F-4712-B	.047	.125	.080	.035
	F-6012-C	.059	.125	.090	.041
	F-6012-B	.059	.125	.090	.041
.125"	F-4715-B	.048	.157	.072	.035

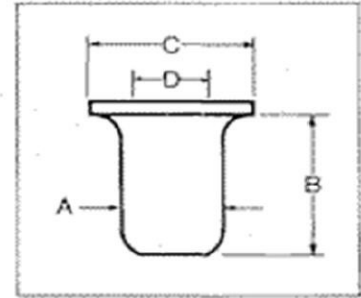

FLAT FLANGE